

| REVISION RECORD | | | | | |
|-----------------|-----|-----------------------------|----------|------|------|
| REV | ECO | DESCRIPTION | DATE | DRFT | APVD |
| 01 | NA | Initial Release | 02/11/08 | SJL | |
| 02 | NA | Add 99444-2 | 05/02/08 | SJL | |
| 03 | NA | Add detail for 10/100 ports | 05/13/08 | SJL | |
| | | | | | |

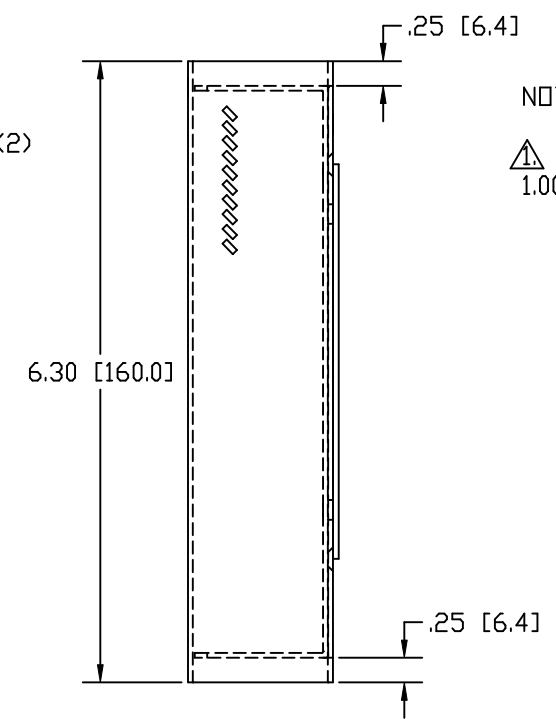

NOTES:
 ▲ THREADED HOLES ARE 6-32. MAXIMUM SCREW LENGTH 1.00 [25.4]

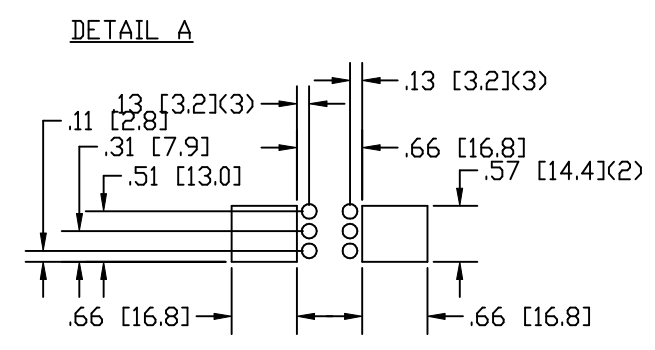
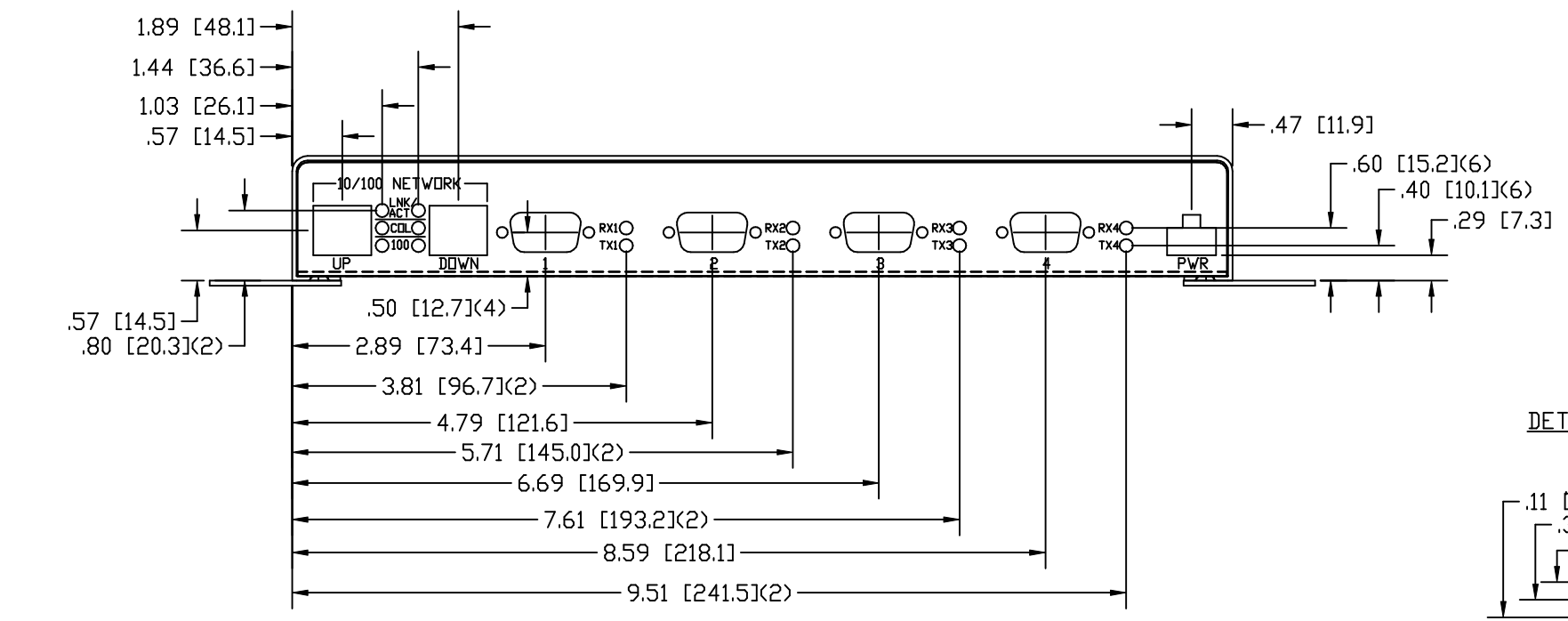

| | | | |
|--|------------------|-----------|--------------|
| DIMENSIONS ARE IN INCHES [MM] | | | |
| CONTROL CORP. | | | |
| TITLE DEVICEMASTER RTS, DB9, 4-PORT | | | |
| 98751-2, 99444-2, 99445-9, 99446-6 | | | |
| FILENAME DM_RTS_DB9_4P_03.DWG | | | |
| BY SJL | DATE 02/11/08 | REV 03 | SHEET 1 OF 1 |